

Part A.**1. Application**

Applicant: Pizza Express (Restaurants) Limited

Premises: Pizza Express, Unit F3 Whiteley Shopping Centre, Whiteley Way, Fareham, PO15 7PD

- 1.1 This report relates to an application for a new premises licence under Section 17 of the Licensing Act 2003 for Pizza Express, Whiteley Shopping Centre.
- 1.2 The purpose of the application is to provide regulated entertainment (recorded music), late night refreshment and supply of alcohol.
- 1.3 The applicant requested recorded music Monday to Sunday 1100 to 0030 each day and New Years Eve 1100 until 1100 New Years Day, indoors only.
- 1.4 Late night refreshment has been applied for Monday to Sunday 2300 to 0030 each day and New Years Eve 1100 until 1100 New Years Day.
- 1.5 The supply of alcohol for consumption on and off the premises is for the hours of 1100 to 0000 each day and New Years Eve 1100 until 1100 New Years Day.
- 1.6 The applicant has agreed to amend their application for the terminal hours on New Years Eve until 0200 New Years Day, following concerns from Hampshire Constabulary.
- 1.7 The applicant has also agreed conditions with Hampshire Constabulary relating to the prevention of crime and disorder and the protection of children licensing objectives. These conditions can be found on pages 8 and 9 below and at Appendix 3a.
- 1.8 A representation was received from a Parish Councillor, Malcolm Smith who has concerns relating to the crime and disorder and prevention of public nuisance licensing objectives.
- 1.9 Cllr Smith has made a representation in a personal capacity, not on behalf of Whiteley Parish Council.
- 1.10 Notice of the application was displayed outside of the premises for a period of 28 days until 14 April 2014, and advertised in the Portsmouth Evening News on 21 March 2014.
- 1.11 Notices of the hearing were sent to all Parties on 29 April 2014.

1.12 The Operating Schedule, copied at Appendix 1, proposes the Relevant Licensable Activities.

Designated Premises Supervisor

Zeynep Bodur

Steps to promote the Licensing Objectives

Please see Section P Appendix 1

Relevant Representations

2. Responsible Authorities

All of the Responsible Authorities have been served with a copy of the application. The representations received are as follows:

Head of Environment

No representations received.

Hampshire Constabulary

Hampshire Constabulary did have concerns with regard to the public nuisance and protection of children licensing objectives. As a result, conditions were agreed with the applicant, as shown in Appendix 3a.

Hampshire Fire and Rescue Service

No representations received.

Child Protection Team

No representations received.

Head of Building Control

No representations received.

Head of Safety Standards

No representations received.

Public Health Manager

No representations received.

Licensing Authority

No representations received.

3. Representations from Other Persons

A representation was received from Malcolm Butler in relation to the prevention of crime and disorder and prevention of public nuisance licensing objectives.

4. Observations

The Sub-Committee is obliged to determine this application with a view to promoting the Licensing Objectives:

- The prevention of crime and disorder
- Public safety
- The prevention of public nuisance
- The protection of children from harm

In making its decision, the Sub-Committee is also obliged to have regard to the National Guidance and the Council's Licensing Policy.

The Sub-Committee must have regard to all of the representations.

The Sub-Committee must take such of the following steps it considers appropriate to promote the Licensing Objectives:

1. Grant the licence subject to conditions in accordance with the operating schedule (modified to such extent as the authority considers appropriate for the promotion of the licensing objectives) and the mandatory conditions;
2. exclude from the scope of the licence any of the licensable activities to which the application relates;
3. refuse to specify a person in the licence as the premises supervisor;
4. reject the application.

Terminal hours

The Sub-Committee should take account of the National Guidance and the Council's Licensing Policy with regard to terminal hours and take such steps as it considers appropriate to promote the Licensing Objectives.

(Licensing Policy Part 4, A8)

Licensing Objectives.

Crime and Disorder

The Sub-Committee should consider any appropriate conditions to prevent crime and public disorder relating to the premises having regard to the operating schedule and the representations.

(Licensing Policy 1.6, 2.11, 2.17)

Public Safety

The Sub-Committee should consider any appropriate conditions relating to public safety having regard to the relating to the premises having regard to the operating schedule and the representations.

(Licensing Policy Part 4, B3, B4)

Public Nuisance

The Sub-Committee should consider any appropriate conditions to prevent public nuisance caused by noise and light pollution from the premises relating to the premises having regard to the operating schedule and the representations.

(Licensing Policy Part 4, Section C)

Protection of Children

The Sub-Committee should consider any necessary conditions for the Protection of Children relating to the premises having regard to the operating schedule and the representations.

(Licensing Policy Part 4, D6, D7)

Human Rights

It is considered that Articles 6 (right to a fair trial) 8 (right to respect for private and family life) and Article 1 of the First Protocol (right to peaceable enjoyment of possessions) may be relevant. As there is a right of appeal to the Magistrates' Court, it is considered that there would be no infringement of Article 6. Article 8 is relevant, insofar as the nearby residents could claim that this right would be infringed by disturbance from customers. This should be balanced against the applicants' right to use of their premises under Article 1 of the First Protocol. Interference with these rights is permitted, where this interference is lawful, appropriate in a democratic society, and proportionate. Likewise, the residents may argue that their rights under Article 1 of the First Protocol would be infringed. If conditions are imposed, there should be no interference with any convention rights. To the extent that any interference may occur, it would be justifiable in a democratic society, and proportionate.

5. Conditions

Mandatory Conditions

1. No supply of alcohol may be made under the Premises Licence (a) at a time when there is no Designated Premises Supervisor in respect of the Premises Licence, or (b) at a time when the Designated Premises Supervisor does not hold a Personal Licence or his Personal Licence is suspended.
2. Every supply of alcohol under the Premises Licence must be made or authorised by a person who holds a Personal Licence.
3. Where individuals are required on premises to carry out security activities, they must be licensed by the Security Industry Authority.
4. The responsible person shall take all reasonable steps to ensure that staff on relevant premises do not carry out, arrange or participate in any irresponsible promotions in relation to the premises.
5. The responsible person shall ensure that no alcohol is dispensed directly by one person into the mouth of another (other than where that other person is unable to drink without assistance by reason of a disability).
6. The responsible person shall ensure that free tap water is provided on request to customers where it is reasonably available.
7. The premises licence holder or club premises certificate holder shall ensure that an age verification policy applies to the premises in relation to the sale or supply of alcohol.
8. The policy must require individuals who appear to the responsible person to be under 18 years of age (or such older age as may be specified in the policy) to produce on request, before being served alcohol, identification bearing their photograph, date of birth and a holographic mark.
9. The responsible person shall ensure that—
 - (a) where any of the following alcoholic drinks is sold or supplied for consumption on the premises (other than alcoholic drinks sold or supplied having been made up in advance ready for sale or supply in a securely closed container) it is available to customers in the following measures—
 - (i) beer or cider: ½ pint;
 - (ii) gin, rum, vodka or whisky: 25 ml or 35 ml; and
 - (iii) still wine in a glass: 125 ml; and
 - (b) customers are made aware of the availability of these measures.

Possible Conditions

If the application is granted, the Sub-Committee may wish to consider the following conditions to reflect the Operating Schedule:

Operating Hours

1. The hours the premises may be used for regulated entertainment shall be:

Recorded music – indoors only

- (i) **Monday to Sunday** **1100 to 0030**
- (ii) **New Years Eve** **1100 to 0200 New Years Day**

2. The hours the premises may be used the provision of late night refreshment shall be:

- (i) **Monday to Sunday** **2300 to 0030**
- (ii) **New Years Eve** **2300 to 0200 New Years Day**

3. The hours the premises may be used for the sale of alcohol shall be:

- (i) **Monday to Sunday** **1100 to 0000**
- (ii) **New Years Eve** **1100 to 0200 New Years Day**

4. The hours the premises may open for other than Licensable Activities shall be:

- (i) **Monday to Sunday** **1100 to 0030**
- (ii) **New Years Eve** **1100 to 0200 New Years Day**

All Licensing Objectives

1. The premises licence holder shall ensure that when licensable activity is taking place and a Personal Licence Holder is not present at the premises, a responsible person aged over 18 shall be present who has written authorisation from the DPS to sell alcohol. This person shall be trained in licensing matters and be fully competent to deal with all licensing issues that may arise within the premises. This persons training shall be documented and made available to the Police and other responsible authorities upon request.
2. The premises licence holder shall ensure that a training package is in place in order for all staff involved with the sale or supply to be sufficiently trained in licensing matters proportionate to their role and aware of their responsibilities.
3. Records shall be kept of this training, dated and signed by the staff member and trainer. Refresher training shall be completed at least every 12 months again with documented records made and to be available for inspection from Police and other responsible authorities.
4. A written record shall be retained to show the staff that staff that have been authorised to sell alcohol. This shall be made available to the Police and other responsible authorities on request.
5. The premises licence holder shall ensure that a system is in place to ensure that every individual who appears to be under 21 years of age seeking to purchase or be supplied with alcohol at or from the premises, shall produce acceptable photographic means of identification and age confirmation. If the person seeking alcohol is unable to produce acceptable means of identification, no sale or supply of alcohol will be made to or for that person.

6. Other Considerations

Corporate Strategy (Relevance To:)

This report covers issues which affect the principles of Active Communities, Prosperous Economy and a High Quality Environment.

Resource Implications

A licence fee of £315 has been received. An annual fee of £295 will be payable on the anniversary of the grant of the licence. It is anticipated that an appropriate level of officer attendance will be provided within the existing budget.

Appendices

1. Application by Pizza Express (Restaurants) Limited
2. Representations by other persons
- 3a. Email correspondence between the applicant and Hampshire Constabulary
- 3b. Map of premises location.

Winchester City Council

Application for a premises licence to be granted
under the Licensing Act 2003

PLEASE READ THE FOLLOWING INSTRUCTIONS FIRST

Before completing this form please read the guidance notes at the end of the form.
If you are completing this form by hand please write legibly in block capitals. In all cases ensure that your answers are inside the boxes and written in black ink. Use additional sheets if necessary.
You may wish to keep a copy of the completed form for your records.

We PizzaExpress (Restaurants) Limited
(Insert name(s) of applicant)

apply for a premises licence under section 17 of the Licensing Act 2003 for the premises described in Part 1 below (the premises) and I/we are making this application to you as the relevant licensing authority in accordance with section 12 of the Licensing Act 2003

Part 1 – Premises Details

Postal address of premises or, if none, ordnance survey map reference or description			
PizzaExpress Unit F3 Whiteley Shopping Centre Whiteley Way			
Post town	Fareham	Post code	PO15 7PD
Telephone number at premises (if any)			
Non-domestic rateable value of premises		£Not yet known – est £75,000	

Part 2 - Applicant Details

Please state whether you are applying for a premises licence as
Please tick yes

- | | | |
|---|-------------------------------------|-----------------------------|
| a) an individual or individuals * | <input type="checkbox"/> | please complete section (A) |
| b) a person other than an individual * | | |
| i. as a limited company | <input checked="" type="checkbox"/> | please complete section (B) |
| ii. as a partnership | <input type="checkbox"/> | please complete section (B) |
| iii. as an unincorporated association or | <input type="checkbox"/> | please complete section (B) |
| iv. other (for example a statutory corporation) | <input type="checkbox"/> | please complete section (B) |
| c) a recognised club | <input type="checkbox"/> | please complete section (B) |
| d) a charity | <input type="checkbox"/> | please complete section (B) |
| e) the proprietor of an educational establishment | <input type="checkbox"/> | please complete section (B) |
| f) a health service body | <input type="checkbox"/> | please complete section (B) |
| g) a person who is registered under Part 2 of the Care Standards Act 2000 (c14) in respect of an independent hospital | <input type="checkbox"/> | please complete section (B) |
| h) the chief officer of police of a police force in England and Wales | <input type="checkbox"/> | please complete section (B) |

* If you are applying as a person described in (a) or (b) please confirm:

Please tick yes

- I am carrying on or proposing to carry on a business which involves the use of the premises for licensable activities; or
- I am making the application pursuant to a
 - statutory function or
 - a function discharged by virtue of Her Majesty's prerogative

(A) INDIVIDUAL APPLICANTS (fill in as applicable)

Mr <input type="checkbox"/>	Mrs <input type="checkbox"/>	Miss <input type="checkbox"/>	Ms <input type="checkbox"/>	Other Title (for example, Rev)	
Surname			First names		
I am 18 years old or over				<input type="checkbox"/>	Please tick yes
Current postal address if different from premises address					
Post Town				Postcode	
Daytime contact telephone number					
E-mail address (optional)					

SECOND INDIVIDUAL APPLICANT (if applicable)

Mr <input type="checkbox"/>	Mrs <input type="checkbox"/>	Miss <input type="checkbox"/>	Ms <input type="checkbox"/>	Other Title (for example, Rev)	
Surname			First names		
I am 18 years old or over				<input type="checkbox"/>	Please tick yes
Current postal address if different from premises address					
Post Town				Postcode	
Daytime contact telephone number					
E-mail address (optional)					

(B) OTHER APPLICANTS

Please provide name and registered address of applicant in full. Where appropriate please give any registered number. In the case of a partnership or other joint venture (other than a body corporate), please give the name and address of each party concerned.

Name PizzaExpress (Restaurants) Limited
Address Hunton House Highbridge Estate Oxford Road Uxbridge UB8 1LX
Registered number (where applicable) 02805490
Description of applicant (for example, partnership, company, unincorporated association etc.) Limited Company
Telephone number (if any)
E-mail address (optional)

Part 3 Operating Schedule

When do you want the premises licence to start?

Day	Month	Year
A	S	A P

If you wish the licence to be valid only for a limited period, when do you want it to end?

Day	Month	Year

A

Please give a general description of the premises (please read guidance note1) Italian style restaurant consisting of ground floor layout plus additional outside seating.

If 5,000 or more people are expected to attend the premises at any one time, please state the number expected to attend.

n/a

What licensable activities do you intend to carry on from the premises?

(Please see sections 1 and 14 of the Licensing Act 2003 and Schedules 1 and 2 to the Licensing Act 2003)

Provision of regulated entertainment

Please tick yes

- a) plays (if ticking yes, fill in box A)
- b) films (if ticking yes, fill in box B)
- c) indoor sporting events (if ticking yes, fill in box C)
- d) boxing or wrestling entertainment (if ticking yes, fill in box D)
- e) live music (if ticking yes, fill in box E)
- f) recorded music (if ticking yes, fill in box F)
- g) performances of dance (if ticking yes, fill in box G)
- h) anything of a similar description to that falling within (e), (f) or (g) (if ticking yes, fill in box H)

Provision of entertainment facilities:

- i) making music (if ticking yes, fill in box I)
- j) dancing (if ticking yes, fill in box J)
- k) entertainment of a similar description to that falling within (i) or (j) (if ticking yes, fill in box K)

Provision of late night refreshment (if ticking yes, fill in box L)

Supply of alcohol (if ticking yes, fill in box M)

In all cases complete boxes N, O and P

A

Plays Standard days and timings (please read guidance note 6)			Will the performance of a play take place indoors or outdoors or both – please tick (please read guidance note 2)	Indoors	<input type="checkbox"/>
Day	Start	Finish		Outdoors	<input type="checkbox"/>
Mon			Please give further details here (please read guidance note 3)	Both	<input type="checkbox"/>
Tue					
Wed					
Thur			State any seasonal variations for performing plays (please read guidance note 4)		
Fri					
Sat					
Sun			Non standard timings. Where you intend to use the premises for the performance of plays at different times to those listed in the column on the left, please list (please read guidance note 5)		

B

Films Standard days and timings (please read guidance note 6)			Will the exhibition of films take place indoors or outdoors or both – please tick (please read guidance note 2)	Indoors <input checked="" type="checkbox"/>	
				Outdoors <input type="checkbox"/>	
				Both <input type="checkbox"/>	
Day	Start	Finish	Please give further details here (please read guidance note 3)		
Mon					
Tue			State any seasonal variations for the exhibition of films (please read guidance note 4)		
Wed					
Thur			Non standard timings. Where you intend to use the premises for the exhibition of films at different times to those listed in the column on the left, please list (please read guidance note 5)		
Fri					
Sat					
Sun					

C

Indoor sporting events Standard days and timings (please read guidance note 6)			Please give further details (please read guidance note 3)		
Day	Start	Finish			
Mon					
Tue			State any seasonal variations for indoor sporting events (please read guidance note 4)		
Wed					
Thur			Non standard timings. Where you intend to use the premises for indoor sporting events at different times to those listed in the column on the left, please list (please read guidance note 5)		
Fri					
Sat					
Sun					

D

Boxing or wrestling entertainments Standard days and timings (please read guidance note 6)			Will the boxing or wrestling entertainment take place indoors or outdoors or both – please tick (please read guidance note 2)	Indoors	<input checked="" type="checkbox"/>
				Outdoors	<input type="checkbox"/>
				Both	<input type="checkbox"/>
Day	Start	Finish	Please give further details here (please read guidance note 3)		
Mon					
Tue					
Wed			State any seasonal variations for boxing or wrestling entertainment (please read guidance note 4)		
Thur					
Fri					
Sat			Non standard timings. Where you intend to use the premises for boxing or wrestling entertainment at different times to those listed in the column on the left, please list (please read guidance note 5)		
Sun					

E

Live music Standard days and timings (please read guidance note 6)			Will the performance of live music take place indoors or outdoors or both – please tick (please read guidance note 2)	Indoors	<input checked="" type="checkbox"/>
				Outdoors	<input type="checkbox"/>
				Both	<input type="checkbox"/>
Day	Start	Finish	Please give further details here (please read guidance note 3)		
Mon					
Tue					
Wed			State any seasonal variations for the performance of live music (please read guidance note 4)		
Thur					
Fri					
Sat			Non standard timings. Where you intend to use the premises for the performance of live music at different times to those listed in the column on the left, please list (please read guidance note 5)		
Sun					

F

Recorded music Standard days and timings (please read guidance note 6)			Will the playing of recorded music take place indoors or outdoors or both – please tick (please read guidance note 2)	Indoors	<input checked="" type="checkbox"/>
				Outdoors	<input type="checkbox"/>
				Both	<input type="checkbox"/>
Day	Start	Finish	Please give further details here (please read guidance note 3)		
Mon	11:00	00:30			
Tue	11:00	00:30	State any seasonal variations for the playing of recorded music (please read guidance note 4)		
Wed	11:00	00:30			
Thur	11:00	00:30	Non standard timings. Where you intend to use the premises for the playing of recorded music at different times to those listed in the column on the left, please list (please read guidance note 5)		
Fri	11:00	00:30			
Sat	11:00	00:30	New years eve – from the end of permitted hours new years eve to the beginning of permitted house new years day.		
Sun	11:00	00:30			

G

Performances of dance Standard days and timings (please read guidance note 6)			Will the performance of dance take place indoors or outdoors or both – please tick (please read guidance note 2)	Indoors	<input checked="" type="checkbox"/>
				Outdoors	<input type="checkbox"/>
				Both	<input type="checkbox"/>
Day	Start	Finish	Please give further details here (please read guidance note 3)		
Mon					
Tue			State any seasonal variations for the performance of dance (please read guidance note 4)		
Wed					
Thur			Non standard timings. Where you intend to use the premises for the performance of dance at different times to those listed in the column on the left, please list (please read guidance note 5)		
Fri					
Sat					
Sun					

H

Anything of a similar description to that falling within (e), (f) or (g) Standard days and timings (please read guidance note 6)			<u>Please give a description of the type of entertainment you will be providing</u>		
Day	Start	Finish	<u>Will this entertainment take place indoors or outdoors or both – please tick</u> (please read guidance note 2)	Indoors	<input type="checkbox"/>
Mon				Outdoors	<input type="checkbox"/>
			Both	<input type="checkbox"/>	
Tue			<u>Please give further details here</u> (please read guidance note 3)		
Wed					
Thur			<u>State any seasonal variations for entertainment of a similar description to that falling within (e), (f) or (g)</u> (please read guidance note 4)		
Fri					
Sat			<u>Non standard timings. Where you intend to use the premises for the entertainment of a similar description to that falling within (e), (f) or (g) at different times to those listed in the column on the left, please list</u> (please read guidance note 5)		
Sun					

I

Provision of facilities for making music Standard days and timings (please read guidance note 6)			<u>Please give a description of the facilities for making music you will be providing</u>		
Day	Start	Finish	<u>Will the facilities for making music be indoors or outdoors or both – please tick</u> (please read guidance note 2)	Indoors	<input type="checkbox"/>
				Outdoors	<input type="checkbox"/>
			Both	<input type="checkbox"/>	
Mon			<u>Please give further details here</u> (please read guidance note 3)		
Tue					
Wed			<u>State any seasonal variations for the provision of facilities for making music</u> (please read guidance note 4)		
Thur					
Fri			<u>Non standard timings. Where you intend to use the premises for provision of facilities for making music at different times to those listed in the column on the left, please list</u> (please read guidance note 5)		
Sat					
Sun					

J

Provision of facilities for dancing Standard days and timings (please read guidance note 6)			Will the facilities for dancing be indoors or outdoors or both – please tick (see guidance note 2)	Indoors <input type="checkbox"/> Outdoors <input type="checkbox"/> Both <input type="checkbox"/>
Day	Start	Finish	Please give a description of the facilities for dancing you will be providing	
Mon			Please give further details here (please read guidance note 3)	
Tue				
Wed			State any seasonal variations for providing dancing facilities (please read guidance note 4)	
Thur				
Fri			Non standard timings. Where you intend to use the premises for the provision of facilities for dancing entertainment at different times to those listed in the column on the left, please list (please read guidance note 5)	
Sat				
Sun				

K

Provision of facilities for entertainment of a similar description to that falling within i or j Standard days and timings (please read guidance note 6)			Please give a description of the type of entertainment facility you will be providing	
Day	Start	Finish	Will the entertainment facility be indoors or outdoors or both – please tick (please read guidance note 2)	Indoors <input type="checkbox"/> Outdoors <input type="checkbox"/> Both <input type="checkbox"/>
Mon				
Tue			Please give further details here (please read guidance note 3)	
Wed				
Thur			State any seasonal variations for the provision of facilities for entertainment of a similar description to that falling within i or j (please read guidance note 4)	
Fri				
Sat			Non standard timings. Where you intend to use the premises for the provision of facilities for entertainment of a similar description to that falling within i or j at different times to those listed in the column on the left, please list (please read guidance note 5)	
Sun				

L

Late night refreshment Standard days and timings (please read guidance note 6)			Will the provision of late night refreshment take place indoors or outdoors or both – please tick (please read guidance note 2)	Indoors	<input checked="" type="checkbox"/>
				Outdoors	<input type="checkbox"/>
				Both	<input type="checkbox"/>
Day	Start	Finish			
Mon	23:00	00:30	Please give further details here (please read guidance note 3)		
Tue	23:00	00:30			
Wed	23:00	00:30	State any seasonal variations for the provision of late night refreshment (please read guidance note 4)		
Thur	23:00	00:30			
Fri	23:00	00:30	Non standard timings. Where you intend to use the premises for the provision of late night refreshment at different times, to those listed in the column on the left, please list (please read guidance note 5) New years eve – from the end of permitted hours new years eve to the beginning of permitted house new years day.		
Sat	23:00	00:30			
Sun	23:00	00:30			

M

Supply of alcohol Standard days and timings (please read guidance note 6)			Will the supply of alcohol be for consumption (Please tick box) (please read guidance note 7)	On the premises	<input type="checkbox"/>
				Off the premises	<input type="checkbox"/>
				Both	<input checked="" type="checkbox"/>
Day	Start	Finish			
Mon	11:00	00:00	State any seasonal variations for the supply of alcohol (please read guidance note 4)		
Tue	11:00	00:00			
Wed	11:00	00:00			
Thur	11:00	00:00	Non standard timings. Where you intend to use the premises for the supply of alcohol at different times to those listed in the column on the left, please list (please read guidance note 5) New years eve – from the end of permitted hours new years eve to the beginning of permitted house new years day.		
Fri	11:00	00:00			
Sat	11:00	00:00			
Sun	11:00	00:00			

State the name and details of the individual whom you wish to specify on the licence as premises supervisor

Name Zeynep Bodur	
Address 7 Dennis Court, Grange Street, St Albans.	
Postcode	AL3 5ND
Personal Licence number (if known) LN/200700549	
Issuing licensing authority (if known) St Albans City and District Council	

N

<p>Please highlight any adult entertainment or services, activities, other entertainment or matters ancillary to the use of the premises that may give rise to concern in respect of children (please read guidance note 8)</p> <p>None</p>
--

O

<p>Hours premises are open to the public Standard days and timings (please read guidance note 6)</p>			<p><u>State any seasonal variations</u> (please read guidance note 4)</p>
Day	Start	Finish	<p><u>Non standard timings. Where you intend the premises to be open to the public at different times from those listed in the column on the left, please list</u> (please read guidance note 5)</p> <p>New years eve – from the end of permitted hours new years eve to the beginning of permitted house new years day.</p>
Mon	11:00	00:30	
Tue	11:00	00:30	
Wed	11:00	00:30	
Thur	11:00	00:30	
Fri	11:00	00:30	
Sat	11:00	00:30	
Sun	11:00	00:30	

P Describe the steps you intend to take to promote the four licensing objectives:

a) General – all four licensing objectives (b,c,d,e) (please read guidance note 9)

The premises are a high quality family friendly restaurant. The vast majority of patrons will be eating. All staff working within the premises will be subject to the company's comprehensive training package incorporating licensing law including a challenge 21 policy. We do not consider that they will pose any threat to the licensing objectives.

b) The prevention of crime and disorder

See a above

c) Public safety

See a above

d) The prevention of public nuisance

See a above

e) The protection of children from harm

See a above

Please tick yes

- I have made or enclosed payment of the fee or
- I have not made or enclosed payment of the fee because the application has been made in relation to the introduction of the late night levy
- I have enclosed the plan of the premises
- I have sent copies of this application and the plan to responsible authorities and others where applicable
- I have enclosed the consent form completed by the individual I wish to be premises supervisor, if applicable
- I understand that I must now advertise my application

- I understand that if I do not comply with the above requirements my application will be rejected



IT IS AN OFFENCE, LIABLE ON CONVICTION TO A FINE UP TO LEVEL 5 ON THE STANDARD SCALE, UNDER SECTION 158 OF THE LICENSING ACT 2003 TO MAKE A FALSE STATEMENT IN OR IN CONNECTION WITH THIS APPLICATION

Part 4 – Signatures (please read guidance note 10)

Signature of applicant or applicant’s solicitor or other duly authorised agent (See guidance note 11). **If signing on behalf of the applicant please state in what capacity.**

Signature	[Redacted]
Date	13 March 2014
Capacity	Poppleston Allen – Solicitors for and on behalf of the applicant

For joint applications signature of 2nd applicant or 2nd applicant’s solicitor or other authorised agent. (please read guidance note 12). **If signing on behalf of the applicant please state in what capacity.**

Signature	
Date	
Capacity	

Contact name (where not previously given) and postal address for correspondence associated with this application (please read guidance note 13)

Vicki Caress
37 Stoney Street
The Lace Market

Post town	Nottingham	Post code	NG1 1LS
------------------	------------	------------------	---------

Telephone number (if any)	0115 934 9176
----------------------------------	---------------

If you would prefer us to correspond with you by e-mail your e-mail address (optional)
v.caress@popall.co.uk

NOTES:
 ALL SETTING OUT MUST BE CHECKED ON SITE
 ALL LEVELS MUST BE CHECKED ON SITE
 ALL FIXINGS AND WEATHERINGS MUST BE CHECKED ON SITE
 ALL DIMENSIONS MUST BE CHECKED ON SITE
 THIS DRAWING MUST NOT BE SCALED
 THIS DRAWING MUST BE READ IN CONJUNCTION WITH THE RELEVANT SPECIFICATION CLAUSES
 THIS DRAWING MUST NOT BE USED FOR LAND TRANSFER PURPOSES
 © BUTLER ASSOCIATES

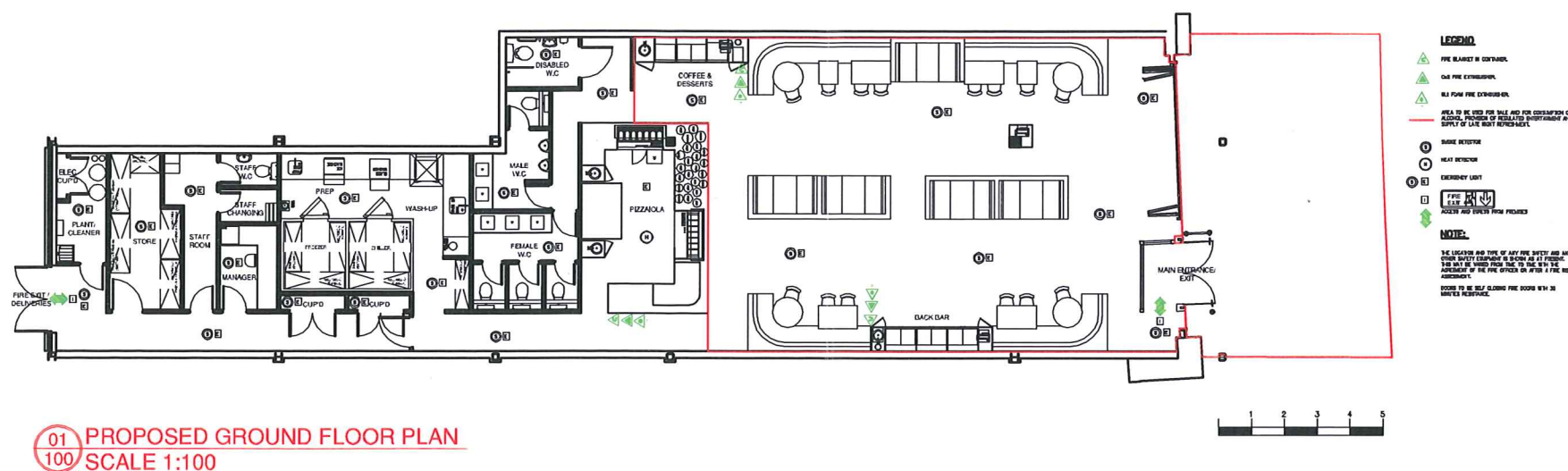

01 PROPOSED GROUND FLOOR PLAN
 100 SCALE 1:100

LEGEND

- ▲ FIRE BLANKET IN CONTAINER
- ▲ ONE FIRE EXTINGUISHER
- ▲ TWO FIRE EXTINGUISHERS
- AREA TO BE USED FOR SALE AND FOR CONSUMPTION OF GOODS, PLACES OF RECEIVING PERFORMANCE AND SUPPLY OF USE MUST BE IDENTIFIED
- SMOKE DETECTOR
- HEAT DETECTOR
- EMERGENCY LIGHT
- FIRE DOOR
- FIRE EXIT
- FIRE EXIT FROM PREMISES

NOTE

THE LOCATION AND TYPE OF ANY FIRE SAFETY AND ANY OTHER SAFETY EQUIPMENT TO BE PROVIDED AT PROPOSED AND EXISTING PREMISES, TO THE BEST OF THE ARCHITECT'S KNOWLEDGE AT THE DATE OF THE DRAWING, SHOULD BE SELF-DECLARING FIRE SAFETY WITH IN LIMITED RESISTANCE.

revision	date	notes

BUTLER ASSOCIATES
 ARCHITECTURE DESIGN & PROJECT MANAGEMENT

9, CHEAM ROAD, EVELL, EPSOM, SURREY, KT11 1SP
 T 020 8224 6000 F 020 8224 5100 E info@butler.co.uk

Client

PIZZAEXPRESS

Location

PIZZA EXPRESS
 UNIT F3
 WHITELEY SHOPPING CENTRE

Drawing

PROPOSED LICENSING PLAN

Date

MARCH 2014

Scale @ A3 = 1:200
 Scale @ A1 = 1:100

Drawing No.

1353/D100

Rev.

From: MALCOLM BUTLER
Sent: 10 April 2014 13:47
To: Licensing
Subject: Re: Premises License Application - Pizza Express Restaurants Unit F3, Whiteley Shopping Centre, Whiteley Way, Whiteley, PO15

Dear Ms Stefanczuk,

I write to object to the license applied for by Pizza Express for the premises to be situated in Whitley Shopping Centre.

My objection is against:

- (1) Late night music until 00.30 Mon - Sun time and the from 11.00 New Years Eve through to 11.00 the next day.
- (2) Late night refreshment 23.00 - 00.30 Mon - Sun and from 23.00 New Years Eve through to 23.00 the next day.
- (3) Supply of alcohol for consumption on and off the premises until 00.00 Mon - Sun and from 11.00 New Years eve through to 11.00 the next day.

My objection is on the material basis of public nuisance to local residents and the prevention of crime and order in the area.

The proposed site (block F) is in close proximity to residents' properties, particularly in Camellia Way and Bluebell Way and the noise would have a detrimental affect to the residents living there. This would be exacerbated by the extra hours on New Years Eve.

The extended sale of alcohol during the week, both to be consumed off and on the premises, would encourage excessive drinking and is likely to encourage crime and disorder, a possible risk to public safety and thus public nuisance.

The extended hours for late refreshment and sale of alcohol on and off the premises on New Years eve through to the the early hours of Jan 2nd is totally unacceptable and is encouraging anti social behaviour through excessive drinking; therefore, again, causing public nuisance and crime and disorder. As an aside, it is also contradicts all attempts made by Government and other agencies to reduce excessive drinking and reduce the on-going cost to the tax payer of such activities.

These extended hours obviously mean that the opening times over the New Year period would be continuous and I also consider that this is not acceptable for Whiteley residents either.

Whiteley is foremost a residential area with developing recreational strands and it's own character needs to preserved as it grows. Residents should be

protected from it becoming a late night entertainment hub with the associated detrimental consequences.

I propose the following as acceptable:

- (1) Late night music and late night refreshment until 23.30 Mon to Sun, with a one hour extension to 00.30 on New Years Eve.
- (2) Supply of Alcohol to be limited to on premises consumption only in line with hours in (1).
- (3) Opening hours on New Years Eve to be limited to 00.30 with a half hour extra for closing premises down.

I would welcome to the opportunity to address the committee to express my objections and I trust my representation will be taken into consideration by the committee.

Yours Sincerely
Councillor Malcolm Butler
Whiteley Parish Council

6 Woodland House
Maple Rise
Whiteley
Hants
PO15 7GW

From: Pearce, Jason
Sent: 19 March 2014 12:48
To: 'Vicki Caress'
Cc: Licensing
Subject: RE: Pizza, Whiteley

Dear Vicki,

Thank you for the prompt reply.

Jason

Dear Winchester Licensing,

I can confirm that the below from Vicki is our agreement so we have no issues with the application.

Many thanks

Jason Pearce
Fareham Police Licensing

From: Vicki Caress
Sent: 19 March 2014 11:21
To: Pearce, Jason
Cc: licensing@WINCHESTER.GOV.UK
Subject: RE: Pizza, Whiteley

Hi Jason

Further to our telephone discussions, I can confirm that my client is happy to accept conditions 1, 3 and 4 as detailed below, and you have confirmed you are prepared to forgo condition 2.

We have discussed the off sales point, which you are now happy with and with regards to the hours for New Year's Eve we have agreed the terminal hour for New Year's Eve into New Year's Day will be 2am.

In the circumstances, are you happy to confirm our agreement?

Many thanks
Vicki

Vicki Caress, Para-Legal
Popleston Allen
T: 0115 9349 176 W: <http://www.popall.co.uk/>

From:

Sent: 19 March 2014 08:44
To: Vicki Caress
Cc: licensing@WINCHESTER.GOV.UK
Subject: Pizza, Whiteley

Dear Vicki,

I write with reference to the new premises licence application for Pizza Express at Whiteley.

The Police position is that the requested extensions of licensable activity are acceptable subject to a few sensible conditions added to the premises licence which I shall list below.

However, the request to extend hours of licensable activity throughout the night on New Years Eve seems a little unnecessary. It is accepted that New Years Eve may require a later extension of hours but 1am would seem to be a fully acceptable terminal hour for licensable activity on that night based on the type of business. Please come back to me on this point.

I'd also be interested in how the premises intend to use the 'off sales' at the premises as is requested in the application.

Requested conditions for agreement to application (assuming NYE issue is agreed).

1. The premises licence holder shall ensure that when licensable activity is taking place and a Personal Licence Holder is not present at the premises, a responsible person aged over 18 shall be present who has written authorisation from the DPS to sell alcohol. This person shall be trained in licensing matters and be fully competent to deal with all licensing issues that may arise within the premises. This persons training shall be documented and made available to the Police and other responsible authorities upon request.
2. The premises licence holder shall ensure that a refusals book / incident book or log is maintained at the premises. These records shall be retained for a minimum of 1 year and be made available to the Police and other responsible authorities upon request.
3. The premises licence holder shall ensure that a training package is in place in order for all staff involved with the sale or supply to be sufficiently trained in licensing matters proportionate to their role and aware of their responsibilities. Records shall be kept of this training, dated and signed by the staff member and trainer. Refresher training shall be completed at least every 12 months again with documented records made and to be available for inspection from Police and other responsible authorities.

A written record shall be retained to show the staff that staff that have been authorised to sell alcohol. This shall be made available to the Police and other responsible authorities on request.

4. The premises licence holder shall ensure that a system is in place to ensure that every individual who appears to be under 21 years of age seeking to purchase or be supplied with alcohol at or from the premises, shall produce acceptable photographic means of identification and age confirmation. If the person seeking alcohol is unable to produce acceptable means of identification, no sale or supply of alcohol will be made to or for that person.

I am conscious that the expiry date for representations is 11th April.

I look forward to hearing from you.

Many thanks

PC Jason Pearce
Fareham Police Licensing

Cc Winchester Licensing FYI.